

# Technical data sheet

## Reduction, PG thread

Item number: 2089408



Reduction (Part H) to DIN 46320, with Pg thread to DIN 40430, as a transition from a PG thread hole to a smaller cable gland.

\* Prices according to DEL notation.



Brass



Nickel-plated

### Master data

Item number	2089408
Type	167 R MS PG42-36
Description 1	Reduction
Manufacturer	OBO
Dimension	PG42-PG36
Material	Brass
Surface	Nickel-plated
Surface standard	
Smallest sales unit	25
Unit of quantity	Piece
Weight	6.75 kg
Weight unit	kg/100 pc.
CO2 Footprint (GWP) Cradle-to-Gate	0,1763 kg CO2e / 1 Piece

# Technical data sheet

## Reduction, PG thread

Item number: 2089408



### Dimensions

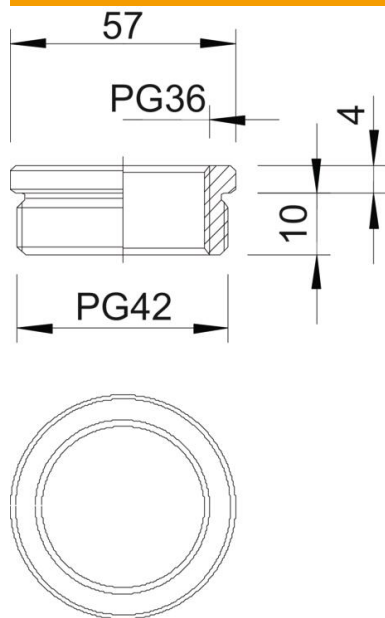

Dimension D	57 mm
Dimension L1	10 mm
Dimension L2	4 mm

### Technical data

explosion-proof	no
Thread type: External thread	PG
Thread type: Internal thread	PG
Thread length	10 mm
Thread dimension, PG, external	42
Thread dimension, PG, internal	36
Nickel-plated	yes