

Technical data sheet

Threaded sleeve for heavy-duty frame cassette

Item number: 7406859



Threaded sleeves for retro-installation in heavy-duty frame cassettes.



VA Stainless steel, grade 354/1

Master data

Item number	7406859
Type	GH RK SL20
Description 1	Threaded sleeve
Description 2	for heavy-duty frame cassette
Manufacturer	OBO
Dimension	L=14,0
Material	Stainless steel, grade 354/1
Smallest sales unit	1
Unit of quantity	Piece
Weight	1.134 kg
Weight unit	kg/100 pc.

Technical data sheet

Threaded sleeve for heavy-duty frame cassette

Item number: 7406859



Dimensions

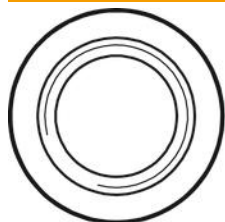

Length	14 mm
Dimension L	14 mm

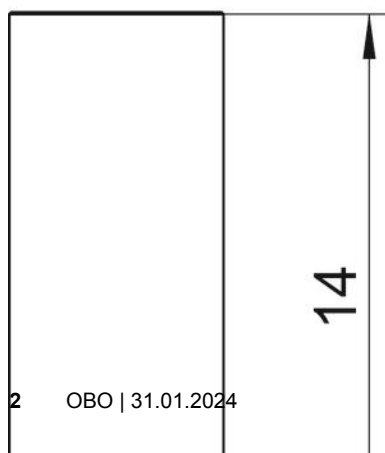
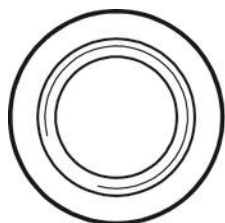
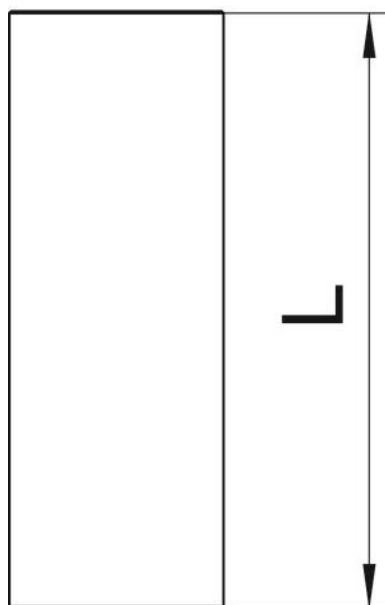

Technical data sheet

Threaded sleeve for heavy-duty frame cassette

Item number: 7406859



Technical data

Thread type

Metric