

# Technical data sheet

## Electrogalvanised steel sleeve, without thread

Item number: 2046856



Accessory part: plug-in sleeve for the connections between electrical installation pipes. With burr-free inner wall.



**St** Steel

**G** Electrogalvanized

### Master data

Item number	2046856
Type	SV25W G
Description 1	Conduit plug-in coupler
Description 2	without thread
Manufacturer	OBO
Dimension	Ø25mm
Material	Steel
Surface	Electrogalvanized
Surface standard	EN ISO 19598 / EN ISO 4042
Smallest sales unit	50
Unit of quantity	Piece
Weight	4.8 kg
Weight unit	kg/100 pc.
CO2 Footprint (GWP) Cradle-to-Gate	0,1172 kg CO2e / 1 Piece

# Technical data sheet

## Electrogalvanised steel sleeve, without thread

Item number: 2046856



### Dimensions

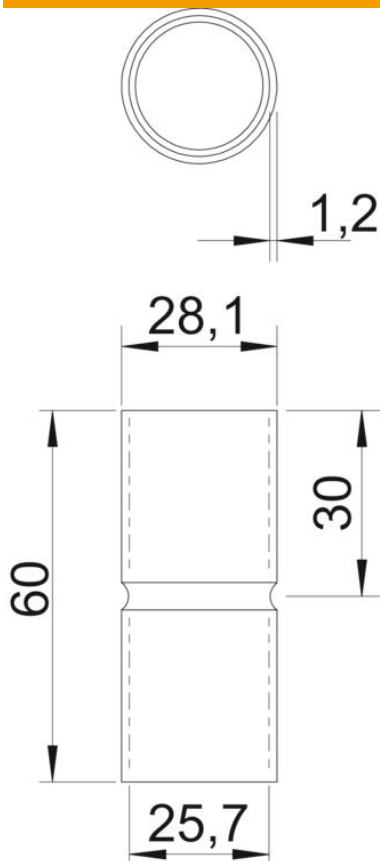

Length	60 mm
Dimension D	28.1 mm
Dimension d	25.7 mm
Dimension L	60 mm
Dimension l	30 mm
Dimension m (mm)	M25
Dimension t	1.2 mm

### Technical data

Version for for pipe diameter	Connector 25 mm
Size	25
Halogen-free	yes
With inspection opening and lid	no
Brushed surface	no
Polished surface	no
Permitted temperature range, max.	400 °C
Permitted temperature range, min.	-45 °C
Two-part	no