

Technical data sheet

EDS plug-in seal, light grey

Item number: 2012350



The push-in nipple can be cut back to suit the relevant cable diameter.



TPE Thermoplastic elastomer

Master data

Item number	2012350
Type	EDS M20 LGR
Description 1	Plug-in seal
Description 2	for 3-mm wall thickness
Manufacturer	OBO
Dimension	M20
Colour	Light grey; RAL 7035
Material	Thermoplastic elastomer
Smallest sales unit	100
Unit of quantity	Piece
Weight	0.125 kg
Weight unit	kg/100 pc.
CO2 Footprint (GWP) Cradle-to-Gate	0,0072 kg CO2e / 1 Piece

Technical data sheet

EDS plug-in seal, light grey

Item number: 2012350



Dimensions

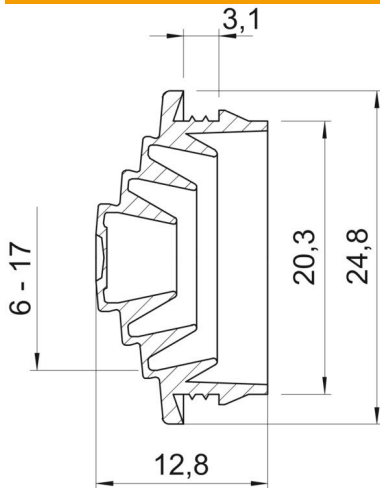

Dimension A	3.1 mm
Dimension D1	24.8 mm
Dimension D2	20.3 mm
Dimension D3	6 mm
Dimension D4	10 mm
Dimension D5	15 mm
Dimension D6	17
Dimension L	12.8 mm
Dimension t	3.1 mm

Technical data

Version for	Cutttable
Flame-resistant	acc. to VDE 0471/DIN 695 Part 2-1, test temperature 650°C
for diameter, max.	17 mm
for diameter, min.	0 mm
for wall thickness, max.	3.1
for wall thickness, min.	2.5
Size	M20
Halogen-free	yes
Nominal diameter	20 mm
Protection rating	IP54