

# Technical data sheet

## Stainless steel pipe bend, V4A

Item number: 2046760



90° bend with moulded sleeves, for electrical installation pipes according to EN 61386-1. With burr-free inner wall.



**A4** Stainless steel

**2B** Bright, treated

### Master data

Item number	2046760
Type	SB16W A4
Description 1	Stainless steel bend
Description 2	without thread
Manufacturer	OBO
Dimension	Ø16mm
Material	Stainless steel 1.4571
Surface	Bright, treated
Surface standard	
Smallest sales unit	5
Unit of quantity	Piece
Weight	7.2 kg
Weight unit	kg/100 pc.
CO2 Footprint (GWP) Cradle-to-Gate	0,3979 kg CO2e / 1 Piece

# Technical data sheet

## Stainless steel pipe bend, V4A

Item number: 2046760



### Dimensions

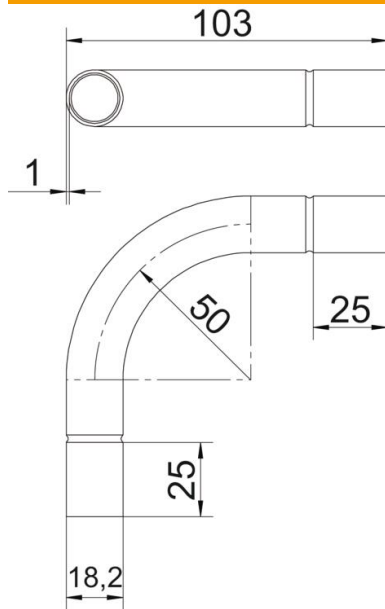

Dimension A	25 mm
Dimension B	103 mm
Dimension D	18.2 mm
Dimension d	16.2 mm
Dimension l	25 mm
Dimension m (mm)	M16
Dimension R	50 mm
Dimension t	1 mm

### Technical data

Version for	Connector
Flexible	no
For nominal pipe diameter	16 mm
Halogen-free	no
With inspection opening and lid	no
With sleeve	yes
Brushed surface	yes
Polished surface	no
Permitted temperature range, max.	400 °C
Permitted temperature range, min.	-45 °C
Angle of the bend	90 °
Two-part	no