

Technical data sheet

Driving head for ST, BP and OMEX earth rods

Item number: 3042200



- Suitable for ST, BP and OMEX systems
- Hardened
- DIN 48852, Form SP

St Steel

Master data

| | |
|------------------------------------|--------------------------|
| Item number | 3042200 |
| Type | 1820 20 |
| Description 1 | Driving head |
| Description 2 | for OMEX earth rod |
| Manufacturer | OBO |
| Dimension | 20mm |
| Material | Steel |
| Smallest sales unit | 1 |
| Unit of quantity | Piece |
| Weight | 62.6 kg |
| Weight unit | kg/100 pc. |
| CO2 Footprint (GWP) Cradle-to-Gate | 1,1885 kg CO2e / 1 Piece |

Technical data sheet

Driving head for ST, BP and OMEX earth rods

Item number: 3042200



Dimensions

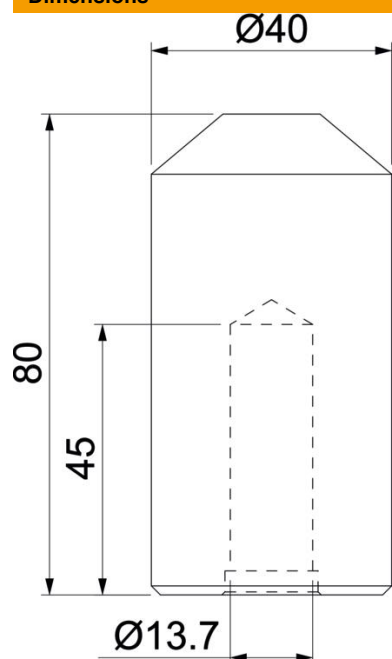

Technical data

| | |
|------------------|------------------|
| Version for | Impact head |
| Design earth rod | BP OMEX Standard |
| for earth rods | 20 mm |