

# Technical data sheet

## Magic bend, variable 60 FT

Item number: 6040512



Magic bend 0°–90°, variable, with quick connector system. For all cable tray types of 60 mm side height.

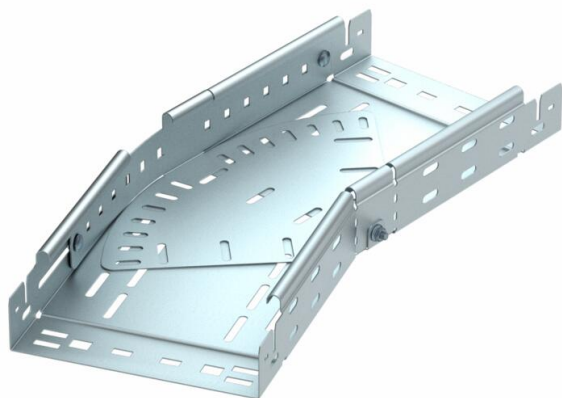

**St** Steel

**FT** Hot-dip galvanised

### Master data

Item number	6040512
Type	RBMV 660 FT
Description 1	Variable bend
Description 2	with quick connector
Manufacturer	OBO
Dimension	60x600
Material	Steel
Surface	Hot-dip galvanised
Surface standard	DIN EN ISO 1461
Smallest sales unit	1
Unit of quantity	Piece
Weight	1480.9 kg
Weight unit	kg/100 pc.

### Dimensions

Width	600 mm
Height	60 mm
Height	2 in
Plate thickness	1.5 mm
Dimension B	600 mm
Dimension L	1,120 mm

# Technical data sheet

Magic bend, variable 60 FT

Item number: 6040512



## Technical data

Bend (angle)	Adjustable
Connector version	Integrated connector
Maintain electrical functions	no
Mounting perforation in base	yes
NATO hole pattern	no
Change of direction	Horizontal
Rustproof steel, pickled	no
Side perforation	yes
Wide-span version	no
Type of connector, cable support system	Click fastening